



FOR LEASE— WAREHOUSE

1572 HAMPTON WAY
SANTA ROSA, CA 95407

Northern California's Premier Commercial Real Estate Firm



Daniel Silewicz

CA BRE # 01988015

Phone: 707-523-2700

Cell: 707-328-1141

Email: daniel@northbayprop.com



William Severi, CCIM, CPM - Broker

CA BRE # 01000344

Phone: 707-523-2700

Cell: 707-291-2722

Email: william@northbayprop.com

The above information, while not guaranteed, has been secured from sources we believe to be reliable. This is not an offer to sell or lease and is subject to change or withdrawal. Any interested party should verify the status of the property and the information herein.



SITE SUMMARY



Site Details

Constriction / Siting:	Metal / Concrete Block
Roll Up Doors:	Grade level
Fire Suppression:	None
Insulation:	Roof Only
Yard:	None
APNs:	125-082-015 & 125-082-014

Hampton Way

North Bay Property Advisors is pleased to offer this industrial complex on Hampton Way, Santa Rosa. The site offers multiple opportunities with smaller spaces with opportunities to expand. The spaces can be combined to create larger contiguous units. The site is located just off Hwy 12, on Sebastopol Rd, which serves as a major corridor to west Santa Rosa and Roseland. No automotive related businesses.



FOR LEASE SUMMARY

Building #1 1536 Hampton Way

UNIT	SPACE	RENTABLE Sq. Ft.	LEASE	BASE Mo. RENT	Est. CAM Mo.	TOTAL Mo. COST
1536 Unit A	Warehouse	3,522 +/- Sq. Ft.	NNN	\$4,050 (\$1.15 per Sq. Ft.)	\$528 (\$0.15 per Sq. Ft.)	\$4,579
1536 Unit B	Warehouse	3,570 +/- Sq. Ft.	NNN	\$4,106 (\$1.15 per Sq. Ft.)	\$536 (\$0.15 per Sq. Ft.)	\$4,641

Building #2 1572 Hampton Way

UNIT	SPACE	RENTABLE Sq. Ft.	LEASE	BASE Mo. RENT	Est. CAM Mo.	TOTAL Mo. COST
1572 Unit A	Warehouse	3,510 +/- Sq. Ft.	NNN	\$4,037 (\$1.15 per Sq. Ft.)	\$527 (\$0.15 per Sq. Ft.)	\$4,563
1572 Unit B	Warehouse	3,330 +/- Sq. Ft.	NNN	\$3,830 (\$1.15 per Sq. Ft.)	\$500 (\$0.15 per Sq. Ft.)	\$4,329
1572 Unit C	Warehouse	2,250 +/- Sq. Ft.	NNN	\$2,588 (\$1.15 per Sq. Ft.)	\$338 (\$0.15 per Sq. Ft.)	\$2,925
1572 Unit D	Warehouse	4,681 +/- Sq. Ft.	NNN	\$5,383 (\$1.15 per Sq. Ft.)	\$702 (\$0.15 per Sq. Ft.)	\$6,085

Building #3 1580 Hampton Way

UNIT	SPACE	RENTABLE Sq. Ft.	LEASE	BASE Mo. RENT	RATE INCLUDES	TOTAL Mo. COST
1580 Unit 1	Storage	590 +/- Sq. Ft.	Modified Gross	\$974 (\$1.65 per Sq. Ft.)	Power, Water, & Sewer	\$974
1580 Unit 2	Storage	605 +/- Sq. Ft.	Modified Gross	\$998 (\$1.65 per Sq. Ft.)	Power, Water, & Sewer	\$998
1580 Unit 3	Storage	590 +/- Sq. Ft.	Modified Gross	\$974 (\$1.65 per Sq. Ft.)	Power, Water, & Sewer	\$974
1580 Unit 4	Storage	1,180 +/- Sq. Ft.	Modified Gross	\$1,711 (\$1.45 per Sq. Ft.)	Power, Water, & Sewer	\$1,711
1580 Unit 5	Storage	1,180 +/- Sq. Ft.	Modified Gross	\$1,711 (\$1.45 per Sq. Ft.)	Power, Water, & Sewer	\$1,711
1580 Unit 6	Storage	1,770 +/- Sq. Ft.	Modified Gross	\$2,567 (\$1.45 per Sq. Ft.)	Power, Water, & Sewer	\$2,567

The above information, while not guaranteed, has been secured from sources we believe to be reliable. This is not an offer to sell or lease and is subject to change or withdrawal. Any interested party should verify the status of the property and the information herein.



EXISTING SITE & FLOOR PLAN

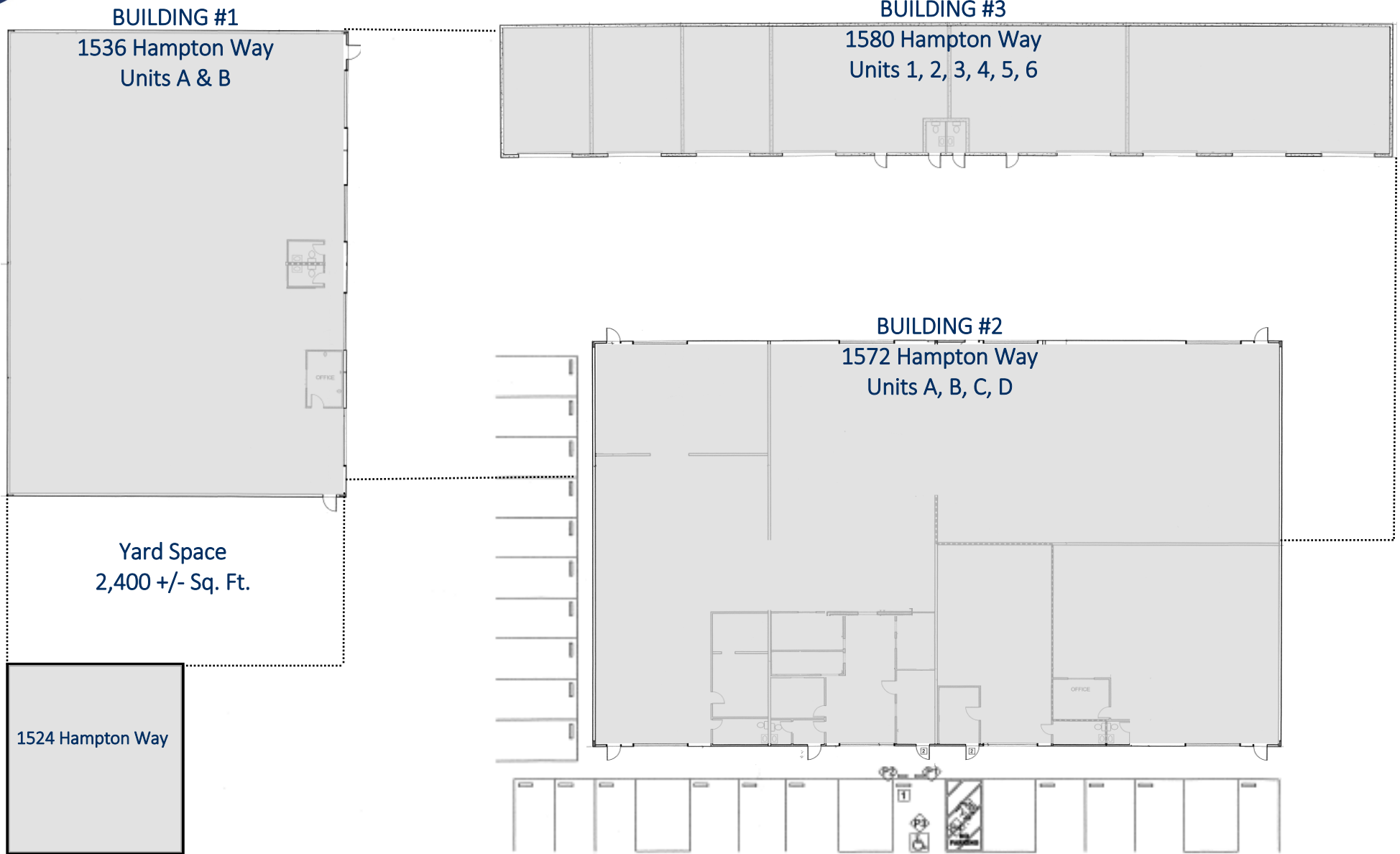



BUILDING #2 1572 FLOOR PLAN

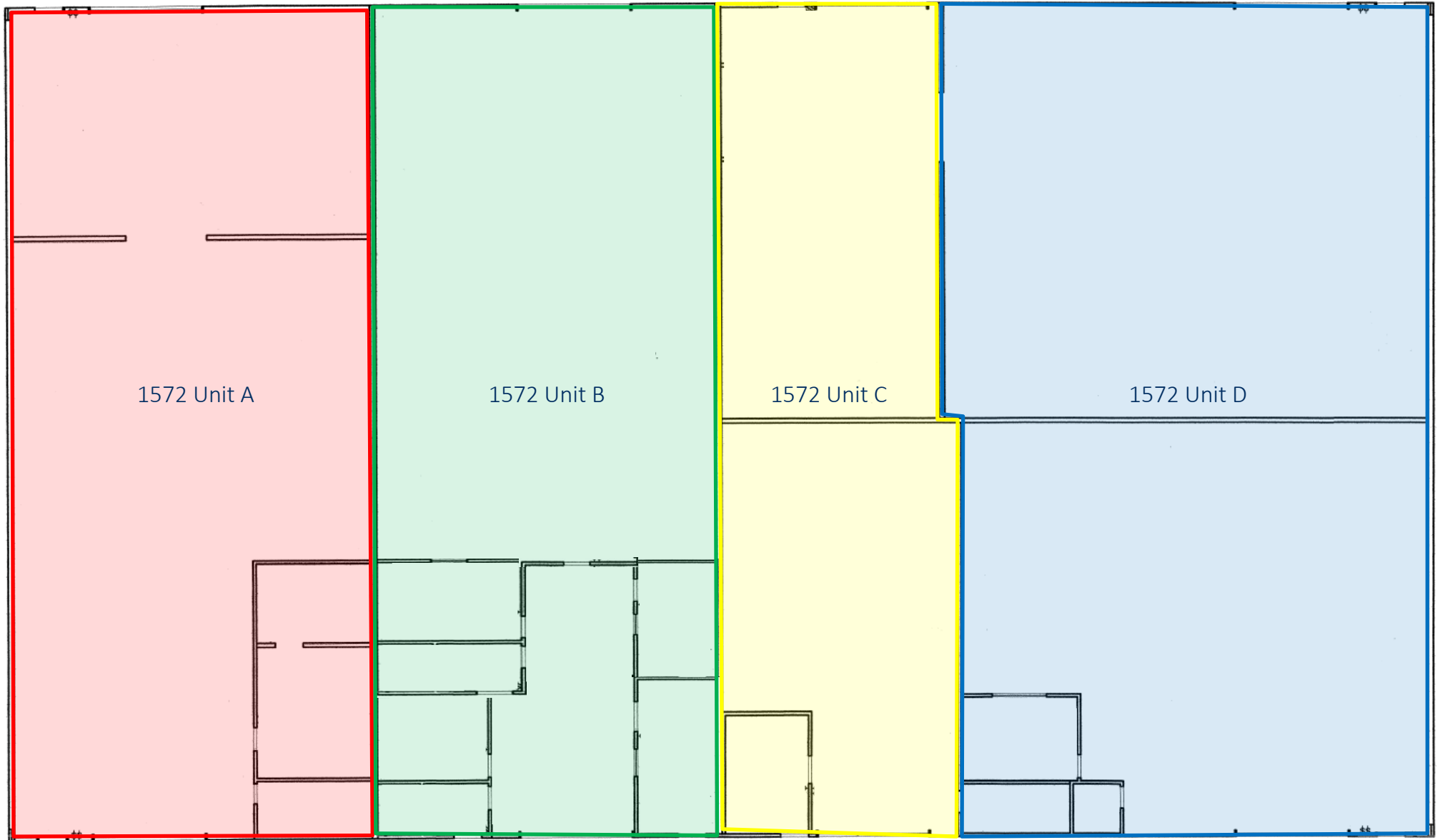

The above information, while not guaranteed, has been secured from sources we believe to be reliable. This is not an offer to sell or lease and is subject to change or withdrawal. Any interested party should verify the status of the property and the information herein.



BUILDING #2 1572 UNIT A



The above information, while not guaranteed, has been secured from sources we believe to be reliable. This is not an offer to sell or lease and is subject to change or withdrawal. Any interested party should verify the status of the property and the information herein.



BUILDING #2 1572 UNIT B



The above information, while not guaranteed, has been secured from sources we believe to be reliable. This is not an offer to sell or lease and is subject to change or withdrawal. Any interested party should verify the status of the property and the information herein.



BUILDING #2 1572 UNIT C



The above information, while not guaranteed, has been secured from sources we believe to be reliable. This is not an offer to sell or lease and is subject to change or withdrawal. Any interested party should verify the status of the property and the information herein.



BUILDING #2 1572 UNIT D



The above information, while not guaranteed, has been secured from sources we believe to be reliable. This is not an offer to sell or lease and is subject to change or withdrawal. Any interested party should verify the status of the property and the information herein.



AERIAL MAP



The above information, while not guaranteed, has been secured from sources we believe to be reliable. This is not an offer to sell or lease and is subject to change or withdrawal. Any interested party should verify the status of the property and the information herein.



STREET MAP

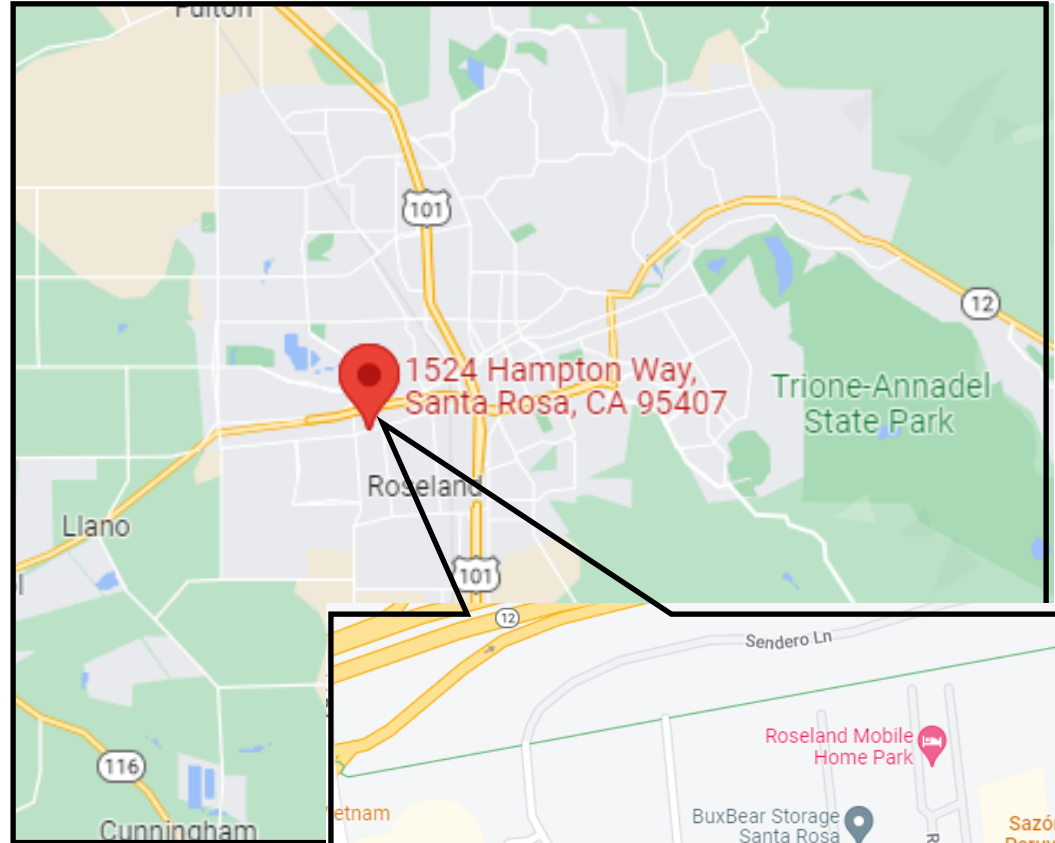
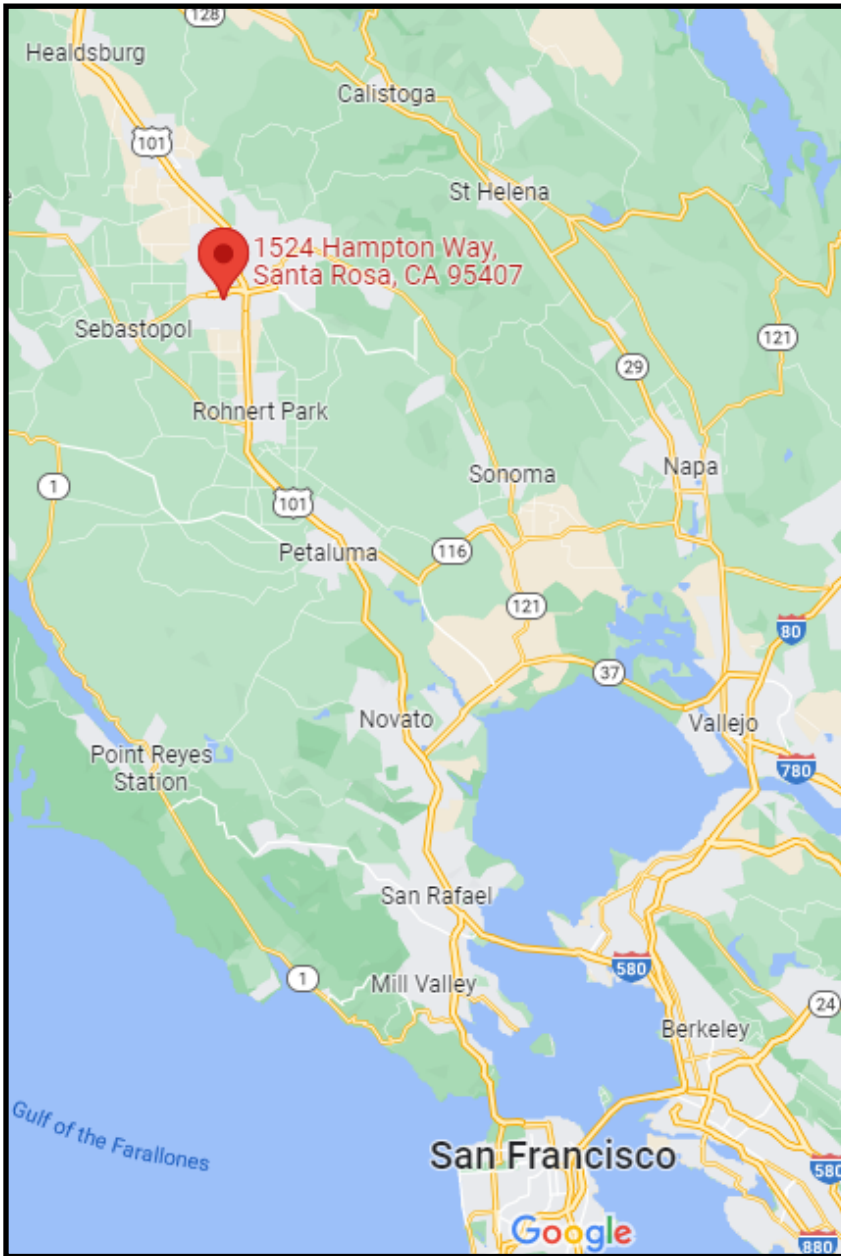

The above information, while not guaranteed, has been secured from sources we believe to be reliable. This is not an offer to sell or lease and is subject to change or withdrawal. Any interested party should verify the status of the property and the information herein.



BROKER TEAM



Daniel Silewicz

CA BRE # 01988015

Phone: 707-523-2700

Cell: 707-328-1141

Email: daniel@northbayprop.com



William M Severi, CCIM, CPM - Broker

CA BRE # 01000344

Phone: 707-523-2700

Cell: 707-291-2722

Email: william@northbayprop.com

North Bay Property Advisors

Santa Rosa Office

2777 Cleveland Ave. Suite 110

Santa Rosa, CA 95403

707-523-2700

www.NorthBayProp.com



NORTHERN CALIFORNIA OFFICES

SANTA ROSA

NOVATO

SONOMA / NAPA

SAN JOSE

SACRAMENTO

WALNUT CREEK

SAN FRANCISCO