



FOR SALE

Cannabis Facility with CUP approval
Offered at: \$8,411,000 (\$265/sq.ft)



2150 Bluebell Dr.
Santa Rosa, CA 95403



Broker: William M. Severi, CCIM, CPM
BRE No.: 01000344
Cell Phone: 707-291-2722
Office Phone: 707-523-2700
Email: Bill@northbayprop.com

North Bay Property Advisors

2777 Cleveland Ave # 110
Santa Rosa, CA 95403
707-523-2700

The above information, while not guaranteed, has been secured from sources we believe to be reliable. This is not an offer to sell or lease and is subject to change or withdrawal. An interested party should verify the status of the property and the information herein.



PROPERTY IMPROVEMENTS

BUILDING	YEAR BUILT	BUILDING SQ. FT.	WAREHOUSE	OFFICE/ RETAIL	SITE
One Story– Warehouse/ Office	1967	31,740+/- Sq. Ft.	23,640+/- Sq. Ft. (74%)	8,100+/- Sq. Ft. (26%)	50,094+/- SQ. Ft. (1.15+/- Acres)

Approximately 31,740 +/- Sq. Ft . warehouse/retail space with 17' to 20' clear height. Seller is obtaining a CUP for Cannabis cultivation with approximately 18,500 sq.ft of canopy. The CUP application reflects 32 flowering and 2 Vegetative rooms.

The exterior of the structure is concrete block, wood and CTU construction. There are five separate bays and 14' roll-up doors with loading docks and one truck ramp. The foundation is concrete slab with areas of stem wall construction. The property has 25 parking spaces with one ADA space. Building has a fire system with sprinklers and fire detectors.



Retail/Boutique

The above information, while not guaranteed, has been secured from sources we believe to be reliable. This is not an offer to sell or lease and is subject to change or withdrawal.

An interested party should verify the status of the property and the information herein.



PSWC Architects

ARCHITECTURE
PLANNING
INTERIOR DESIGN

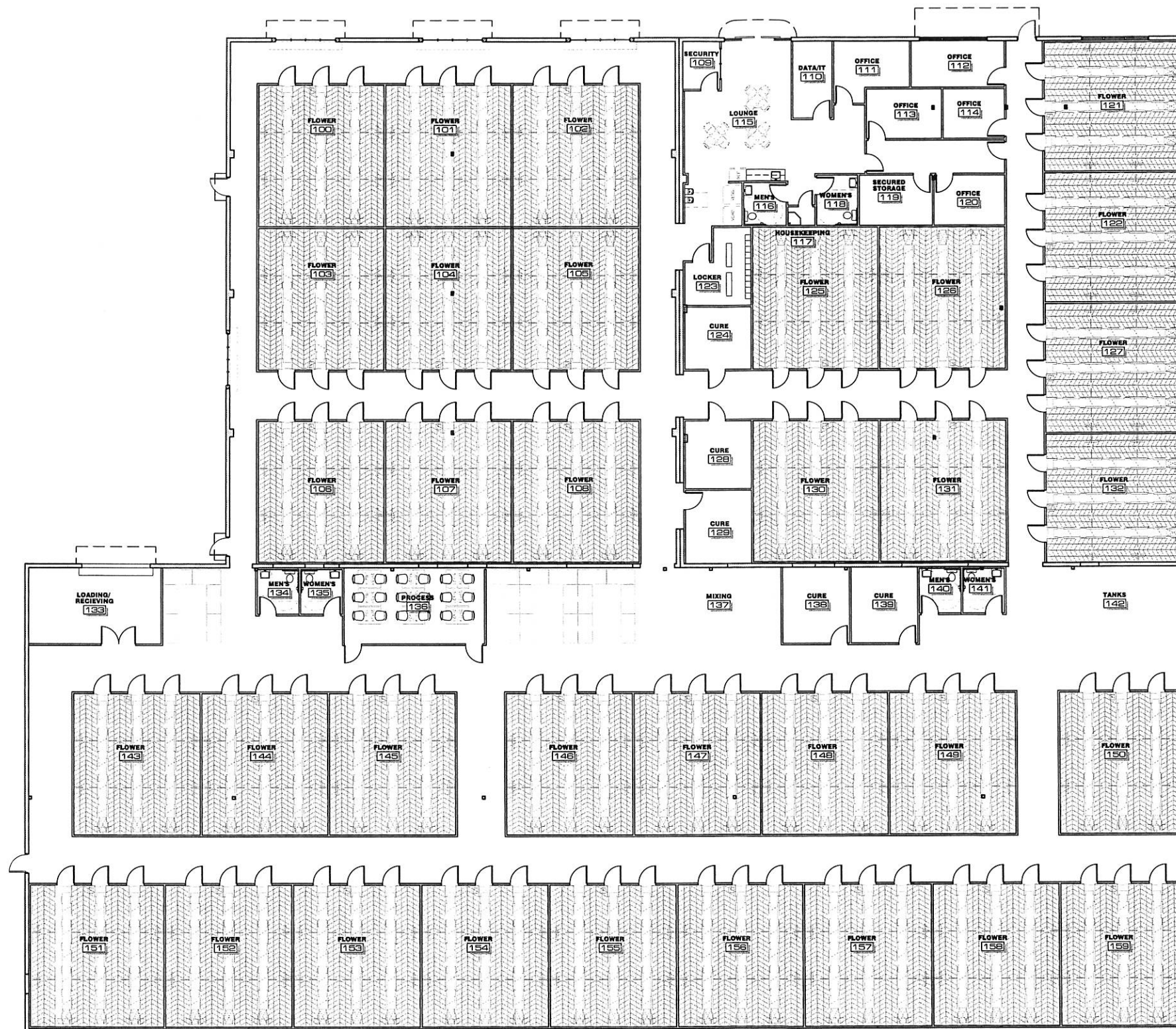

FLOOR PLAN - PROPOSED

SCALE : 1/8" = 1'-0"

REVISION 3.3



**CULTIVATION FACILITY
2150 BLUEBELL DRIVE,
SANTA ROSA, CALIFORNIA**

APN: 015-370-065

© Copyright PSWC Architects
January 17, 2017

Attachment 4
Proposed Medical Cannabis Cultivation CUP Application
Kanaplya

January 14, 2017

Name: Kanaplya
Address: 2150 Bluebell Drive
APN: 015-370-065
Zoning: IL
Gen. Plan: Light Industry
Bldg. Size: 31,500 ft²
Lot Size: 60,000 ft²

The purpose of this plan is to describe Kanaplya's compliance with the City of Santa Rosa, California and detail the operations of the cultivation facility. The plans describe in detail how Kanaplya will maintain a discreet, agreeable, and secure environment to cultivate the highest grade medical cannabis while being in strict compliance with state and local ordinances and laws.

Benefits to the Community that should be noted:

- The creation of up to 30 living wage jobs
- Anticipate translocation of cannabis production from neighborhoods
- Improved traffic flow
- Increased safety and security conditions in the neighborhood

Conditional Use Permit

Conditional Use Permit is attached

Signed Application

The property owner, Igor Dekhterman, has signed the application for the conditional use permit.

PROJECT DESCRIPTION

Kanaplya is proposing to retrofit the industrial building at 2150 Bluebell Drive into a medical cannabis cultivation business. The existing building is currently the location of Crossing the Jordan, which is a non-profit donation, storage, and sorting center. Crossing the Jordan is currently operating with approximately 8,000 ft² of office and retail space.

The location is 203 feet from the nearest residential zoning, the planned development at the corner of Coffey Ln and Bluebell Drive. The site is greater than 600 feet from the nearest school, North Valley School Elementary.

The site currently has a parking lot, 4 street access ramps to Bluebell Drive, and truck docks on the front of the building. There is a dock high loading ramp access which is fenced at the west of the building that will be utilized for secure shipping and receiving. The new company will continue to use

the existing retail entrance. Employees will enter the building past a new security station to be located at the northwest corner of the office area. The other existing man doors will remain to be used only as emergency exits. The front loading docks are to be permanently closed and replaced with CMU blocks designed to match the adjacent block walls and new windows will be installed at the top of the existing openings for natural light to the interior.

The traffic generated by the project will be consistent with other manufacturing facilities of this size in the area. It is projected to generate over thirty employment positions. Since the facility will be in operation 24 hours a day, 7 days a week Kanaplya intends to schedule four shifts daily. Kanaplya will maintain reduced staff levels at night, on weekends, and holidays. There will be a security guard on the premise 24/7. There will be deliveries and shipments to and from the business several times per week. These deliveries will be in a LTL delivery sized truck and by freight. Traffic generated by the new business will be significantly less freight than the current business, similar in terms of staff, and there will no longer be retail visitor traffic.

The noise level is expected to be similar or less than the current business as all business activities will be housed within the existing concrete building. All loading and unloading of materials and refuse will be done during regular business hours by means similar to other businesses in the area, i.e. by forklift and trash truck.

The building modifications will primarily be to the interior except for the following: closing two of the existing access drives to Bluebell, removing three of the existing loading doors, the addition of mechanical equipment to the roof, parking lot re-paving and striping, and security lighting and cameras.

PLOT PLANS OF CULTIVATION CENTER

Included are the following:

- Site Plan
- Existing Building Elevation Photo
- Floor Plan
- Exterior Elevations
- Neighborhood Context Map
- Vicinity Map with North Arrow

INDEMNIFICATION FORM

The Indemnification Form is signed and attached.

DISCLOSURE FORM

The Disclosure Form is signed and attached.

NEIGHBORHOOD MEETING

Kanaplya is located within 300 feet of residential zoning and conducted the required neighborhood meeting Wednesday January 11th at 7:00pm. Several residents of the neighborhood came to be part of the dialogue and most of the concerns seemed to revolve around odor and property value. We spoke openly with the concerned parties describing the day to day staff levels, standards for employment and general business practices. There were no major objections to the project voiced by any in attendance to this meeting.

DESIGN REVIEW

Over the counter (OTC) Design Review will be needed. The building modifications will be interior except for some minor exterior alterations listed above. The building modifications will primarily be to the interior except for the following: closing two of the existing access drives to Bluebell, removing three of the existing loading doors, the addition of mechanical equipment to the roof, parking lot re-paving and striping, and security lighting and cameras.

ENVIRONMENTAL ASSESSMENT

The Environmental Assessment Application is attached.

DISTANCE TO SCHOOLS

Kanaplya complies with all applicable provisions of the Zoning Code and the City Code. Kanaplya is not located within 600 feet of a school. "School" is defined by the state of California to mean any public or private school providing instruction in kindergarten or grades 1 to 12. The sensitive businesses within 600 feet are Santa Rosa Gymnastics and Stan Bennett's Health and Fitness. Kanaplya will ensure no impact will occur by utilizing indoor employee break area and kitchen, in-door locker area, and on-site screened parking for all employees. Employees will not be permitted to loiter in the parking areas or in front of the building.

SECURITY PLAN

Security personnel from a licensed security company will be on-site 24/7.

Access Controls

Kanaplya will provide and install a variety of security devices to ensure that only authorized personnel have access to any location where medical cannabis is stored to insure employees are safe and secure inside Kanaplya.

All access points from outside of the facility will have locks, alarms contacts, and security cameras. All perimeter windows and hatches will remain closed and locked with tamper-proof security devices and alarm contacts. The openings will be equipped with perimeter alarms that will sound if there is any breach of these apparatuses. All external doors will require two (2) levels of security verification to open something known such as a code, and something held such as a key. This security process means that employees will need a key along with a unique access code to unlock the front door or any other external door. In the event of theft or loss of medical cannabis, these devices will also provide a security log of who accessed the doors for any ensuing investigations. In addition, our camera system will provide visual confirmation of the individual entering and exiting the facility.

All doors will be equipped with an alarm that will sound if they are opened without code and key or if they are damaged. Arming and disarming the security system will require an access code. Both the entry alarm and surveillance systems will notify the monitoring service if a failure is detected in either of the systems, which will be corrected as soon as possible. In the event that the failure prevents security systems from operating, the facility will take additional security measures until it is fixed.

Alarm systems can also be triggered if an employee presses a panic or duress button. These buttons will be installed in strategic locations only accessible to employees. The panic button should be pressed when there

is a theft or breach and the employee or other people would not be placed in danger by a loud alarm. The duress button will still notify authorities just like a typical alarm, but not make any sound. These security devices will allow employees who are threatened to signal an alarm without escalating the situation.

Video Surveillance System

Kanaplya will provide a comprehensive surveillance system. All cameras will be high resolution and located strategically to adequately capture images of people and movement throughout the Kanaplya facility. The extensive surveillance system will have capabilities to include remote monitoring by any outside agencies and data back-up on off-site servers for at least 90 days. The video server will be located in the locked IT room, security staff will be able to view and control the facility's cameras through several monitors located in the on-site security office. A high resolution printer will allow for security staff to produce clear still photography from any live or recorded video on demand to provide to law enforcement, in the event of a security breach.

The video surveillance system is configured to allow for the exporting of still images in a variety of standard formats like .jpg or .bmp so that they can be digitally transferred. Digital images will also have data protection that prevents digital alteration and allows for a date/time stamp of both the image and the file creation to be authenticated. Video or still images exported from the system can be viewed on any standard computer operating system, such as Windows or Mac. The on-site system will be located in a secure IT room that only the GM and IT personnel will be able to access. The images from all cameras will have a date/time stamp to allow verification of video integrity during the life of Kanaplya.

Electronic Security System

In addition to the surveillance system, Kanaplya will implement a comprehensive electronic security system, including third party monitoring of all alarms; intrusion detection alarms, and panic/duress buttons at strategic locations within the facility. The intrusion detection system will use appropriate methods (such as pressure sensitivity, lasers, magnets, etc.) to determine if any entrance, exit, or window has been breached without authorization. The duress and panic buttons will be placed in several locations throughout the building.

Failure Notification System

The security systems will include a failure notification system to provide an audible, visual and text notification of any failure in the surveillance or alarm system. The audible and visual notifications will be on-site at the equipment monitoring station. A text alert will go out to designated cultivation agents within five minutes after the failure, including the Principal Officers, General Manager (GM), and any shift leaders. These notifications will be in both text message and email form. The message will include the time of failure, type of failure, cause of failure (identified), extent of systems malfunctioning, and contact information for the security company.

Electrical Backup Systems

Kanaplya will use a battery backup power system sized sufficiently to provide emergency power to video

cameras, alarms, sensors, panic buttons and computers in the event of a total power outage. This backup power supply will maintain all vital security and life safety systems for a sufficient time to deter theft or diversion by individuals who want to create or take advantage of a power outage.

Surveillance Recording Access Controls

Only authorized security and appropriate management personnel will be allowed to access the surveillance monitoring and recording area. This secured area contains a terminal at which all of the security devices in the facility can be monitored and adjusted, and the surveillance archive can be viewed and printed. The terminal will be in an isolated area with a locked door that only the Principal Officers, and IT Agents will have access to. Law Enforcement and the City of Santa Rosa will be provided access by authorized personnel, upon request and verification of appropriate organization credentials.

Emergency Procedures

Kanaplya has procedures in place in case of an emergency. Training will be provided to employees in case of fire, flood, or other natural disaster. If the employees cannot safely leave the building, there will be an emergency kit that contains food, water, and other supplies.

LIGHTING

Statistics show that crimes are less likely to occur in well-lit areas because robust lighting is an excellent deterrent. Security lighting is one of the most practical and effective ways to prevent crime in and around the cultivation center. Currently, there are several HID fixtures at the front of the building and on the loading dock side. Total consumption of 2800 Watts/hrs. In addition, there are 2 flood lights 1000 Watts each (with ballast 1100 Watts) on the back side of the building. Total consumption of 2200 Watts/hr. The company plans to upgrade the exterior lighting.

Exterior lighting retro fit to the site will entail replacement of all existing HID lighting for new energy efficient LED fixtures. All new lighting fixtures will meet current energy standards and be dark sky compliant. The new lighting plan will add to the security of the facility.

FENCING

Existing fencing and gates will be utilized. Fencing and gates are galvanized chain link securing the loading area.

PRODUCT SECURITY PLAN

Inventory Control

The GM will implement and strictly oversee the real-time, web-based inventory control system, which will be accessible by the City of Santa Rosa 24 hours a day, seven days per week. This system will keep meticulous track of every bit of medical marijuana on-site until the product is either purchased or Kanaplya disposes of it. All medical marijuana produced by Kanaplya will be entered into the inventory system immediately with all identifying information. This includes the registration number of the agent making the entry, date/time, quantity, strain, and batch number.

Loss Documentation Procedures

All employees will be trained to report loss or theft of product to the Principal Officers or GM who will, in turn, promptly document the loss and report the loss or theft to local police by phone and mail. The GM will conduct an investigation to identify what was lost, the source of the loss, which cultivation agents were overseeing the operations where and when it occurred, and security evidence such as video surveillance footage. All actions taken in the course of the investigation will be thoroughly documented and provided to the local law enforcement for review and to assist their investigations.

The report will include the following information: a) the name and address of Kanaplya; b) the amount and type of marijuana lost or stolen; c) the circumstances surrounding the loss or theft; d) the date and time of the loss or theft) the date the loss or theft was discovered) the name of the person who discovered the loss or theft; g) the name of the person suspected for the loss or theft, if known; and h) all video and other relevant evidence uncovered in the initial investigation.

AIR QUALITY PLAN

Kanaplya's air filtration systems will utilize multiple stages of activated carbon throughout the facility to absorb and reduce odors and irritants inside for the employees and to negate off-site odors. Kanaplya's designs are to include multiple smaller chambers for cultivation inside the warehouse there by creating an additional envelope further reducing odor transmission. The building will be designed to be under slight negative pressure and all air exiting the building will be filtered thru carbon canisters to greatly reduce odors. Additionally fans will be used to create air circulation and reduce air stagnation in the facility. Kanaplya's air filtration system will be inspected and properly maintained to ensure continuing air quality.

SIZE

Kanaplya's facility is sufficient in size to properly store and control the volume of medical marijuana Kanaplya plans to cultivate and distribute. The facility is also adequate in size to provide enough comfortable space for personnel and visitors such as a locker room and dining amenities. Kanaplya has space for a designated security office that will house a private security officer where surveillance video footage and other security information will be maintained.

FACILITATING CLEANLINESS

Kanaplya will conduct daily cleanliness and sanitation practices that are designed to protect medical marijuana products from contamination, pests, and contact with foreign substances. Cultivation agents and other staff will complete daily indoor and outdoor cleaning activities in order to maintain a comfortable environment. All agents will use appropriate sanitary tools such as Tyvek suits and gloves to minimize any risk of contamination.

STATE AND LOCAL BUILDING AND FIRE CODES

Kanaplya's building and site are designed to meet the standards established by the City of Santa Rosa and the State of California.

STAFFING PLAN

Kanaplya plans to cover its work schedule with primarily full-time employees eligible for full benefits as

mandated by California state laws. In addition to the planned full-time employees, part-time employees will also be required to ensure that all shifts are covered.

Estimated Staffing Levels

Kanaplya estimates that there will be at least 30 employees. This staffing includes one General Manager, one Cultivation Manager, two (2) full-time administrators, twenty (20) full-time cultivation staff, and ten (10) part-time Cultivation Agents. Shifts will be created to ensure that employees receive adequate breaks and sick days as required by California labor laws. Scheduling will be done to maintain adequate staff levels on all shifts. Shifts will be created so there is adequate space on-site for vehicular traffic and in common areas throughout the facility. The General Manager and Cultivation Manager will be present five (5) days per week and will be on call for emergencies.

Agent Acquisition

As a condition of employment, all potential agents must submit fingerprints to an approved Live Scan vendor and pass an electronic background check completed by the DOJ and FBI. Kanaplya anticipates hiring individuals from the surrounding community and will market its hiring campaigns in order to accomplish this.

Agent Training and Education

All newly hired agents will receive training on medical marijuana. Staff training will be ongoing, and will cover such topics as: safety awareness, emergency procedures, inventory control, marijuana strains and benefits, and any other job-specific requirements to ensure agents remain compliant with state and local regulations and have opportunities for ongoing professional success. Weekly employee training sessions will be conducted, which will cover a review of all security and emergency procedures, compliance with state and local regulations, and address any training deficiencies or clarification needed.

CULTIVATION OPERATION PROCEDURES

Kanaplya has developed rigorous strategies and methods to ensure that its medical cannabis products will be available on the market in the shortest timeframe possible, while still ensuring quality. We recognize that the foundation of future success for operations will be based on the quality and safety of our medical cannabis. All employees will be thoroughly trained in cultivation procedures to ensure a consistent, quality product.

SANATATION PROCEDURES

Kanaplya recognizes that the integrity of its brand and associated cannabis products will come from its ongoing commitment to ensure the biosecurity of the cannabis plants that form the basis of its production and the Cultivation Facility where production occurs. The biosecurity of the cultivation facility will be strictly maintained. Employees and authorized visitors will enter the cultivation facility through a secure entrance. Upon receiving security clearance, persons entering the cultivation facility will be subject to the following sanitization procedures:

1. No personal items will be allowed inside the cultivation area. Items may be securely stored in office areas.
2. Persons entering the cultivation facility will be screened for hygienic condition and must undergo hygienic practices as necessary.
3. Persons entering the cultivation facility will be required to put on designated clean-room garments covering their hair and shoes.
4. Persons exiting the cultivation facility for any purpose must remove all clean-room garments and follow the preceding steps before re-admittance.

TRAINING

It is important to both the medical cannabis patient community of California and to The Company that the employees are highly educated in cannabis cultivation. Employees will not be allowed to work without completing the necessary training. In addition to the company-mandated training, The Company strongly encourages all employees to study cultivation practices and to conduct background research on medical cannabis in order to fully immerse themselves in this industry. The Company encourages open communication about the industry and best practices.

WORKDAY PROCEDURES

In a typical workday, cultivation employees will be working with plants at all stages of growth. In general, cultivation employees will be expected to: report to work in a timely manner, taking into consideration the extra security measures mandated for employees to enter the facility. Follow all company-wide security procedures and protocols. Follow all cultivation procedures and protocols as set by the company. Report any plant health issues. Complete all daily tasks in a timely manner to ensure a timely harvest.

THE VEGITATIVE PROCESS

The goal during the vegetation state is to encourage rapid growth of the cannabis plants in order to create the height and structure necessary for flower production. The cannabis plant is naturally in this state during the spring/summer season when there is more light than darkness. Vegetation Division staff must maintain the lighting in the Vegetative Growth Area at eighteen (18) hours on, six (6) hours off, to mimic these conditions found in nature and induce the plant to continue to grow. Clone cuttings are planted in the soil mixture and then laced in trays to grow into teen plants. During the vegetation stage, teen plants will be encouraged to grow rapidly until they reach approximately two (2) to three (3) feet high and have enough branches with potential flower sites to be successful in the flowering process. The Company has developed comprehensive procedures to manage the development of cannabis plants during this stage in their life cycle.

Teen plants will remain in vegetation until they grow into pre-flowering adults with a required height of two (2) to three (3) feet. This period of growth usually lasts approximately one (1) month. During this time, employees will maintain the plant utilizing the following cultivation practices designed to encourage vigorous growth:

Topping: Cutting the tops off of growing branches. The result is that the branch will split into two branches, thus increasing the total number of branches. This process can be replicated effectively doubling the amount of potential flowering sites optimizing overall yield.

Fimming: Similar to topping except that only a portion of a growing top is cut to force new growth below the damaged area. This causes the growth hormones in the plant to be forced downward resulting in three to four potential flowering sites to be produced.

Pruning: Required when the plant is one to two feet tall and continues throughout the entire cycle. All leaves and smaller branches on the lower region of the plant will be removed to promote upward growth by allowing the plant to utilize its energy toward growing the upper area that is more likely to produce the best flowers and receive the most light.

Bending: Encouraging the plant to bend toward a specific area of concentrated light that will allow maximum light penetration for other areas that are not receiving as much light. As the plant's top branch turns toward the light, it allows the light to illuminate other areas of the plant and creates more potential flowering sites that produce larger flowers.

Super Cropping: Bending a branch so it breaks but does not snap off, leaving most of the plant tissue on the stem together so that it holds firmly. This sends plant growth hormones down the branch below the break and causes

other new flower sites to grow. The result produces a more optimized yield while letting other flower sites receive more light.

THE FLOWERING PROCESS

The goal during the flowering stage is to produce the maximum amount of dense buds with as much medicinally active cannabis compounds as possible.

The Company will train employees to understand and implement the following flowering procedures:

1. Flowering Division staff must maintain the lighting in Flowering Pods at twelve (12) hours on, twelve (12) hours off, to mimic these conditions found in nature and induce the plant to produce flowers. The cannabis plant produces flower and THC-containing resin to attract pollen in order to reproduce and produce seeds and is naturally in this state during the fall season when there is about the same amount of light as darkness.
2. The tops of the plants are weaved into netting to help keep them from falling over from their own weight as flowering plants will produce very large dense buds.
3. Branches will be intertwined into the screening to keep the plant in the proper position and maintain its proportions to the lighting above. During the first two (2) weeks of flowering, plants will grow quickly, usually doubling in size before the tops of the plant start to form flowers. At this stage, branches will still be growing but the plant will shift its focus towards forming flowers rather than new sets of leaves. You must closely monitor plant growth and adjust grow lighting to maintain a constant distance of two (2) to three (3) feet above the top of the plant canopy to avoid heat-related damage. Oscillation fans will also be pointed in the area directly above the plant canopy to help reduce ambient air temperature surrounding tops of plants.

THE CLONING PROCESS

All employees involved in the cloning process will undergo thorough training. The cloning process employees will follow is:

1. Use a sterile and sharp instrument to cut the mother plant at potential flowering sites (internodes).
2. When a cutting is taken, there will be at least two or more leaves present on the resultant branch to maximize the success of the potential clone.
3. Once the cutting is taken, place the stem in water immediately to prevent an air bubble from forming in the stem.
4. After a cutting has been produced, scrape the cambium layer at the bottom of the cut stem to provide more surface area for roots to grow.
5. After scraping the cambium layer, cut the two sets of leaves on the cutting in half to reduce the rate of transpiration while roots are forming.
6. Dip the prepared cutting in a rooting hormone gel that has the necessary nutrients and hormones to encourage root growth.
7. Place the cutting into the cloning machine. The cloning machine is designated to create the ideal environment for root production with spray jets misting water and nutrients at the base of the stem where roots are produced.

HARVESTING

All employees involved in the harvesting process will undergo thorough training. A general outline of harvesting duties is detailed as follows:

1. Staff will cut flowering plants ready to be harvested from their main branch and hang them upside down on racks to dry out excess water weight.

2. Staff will place each plant at least three (3) feet above the ground and separated by a few inches. In this position, plants will be left to complete the drying process, which typically takes approximately one (1) to two (2) weeks before the cannabis flowers are ready to be trimmed.
3. When the texture of the plants is dry and feels crisp, they are ready to be moved to the trimming room for trimming procedures as further detailed in the next section.

TRIMMING

Staff will be thoroughly trained in trimming procedures, which are outlined generally as follows:

1. Trimming staff will begin the plant manicuring process by using automated machines to remove the bulk of excess plant material (leaves, stems, etc.). Hand tools will then be used to complete the necessary detail work.
2. The material trimmed from cannabis plants contains active medicinal compounds. The trimmed contents of each plant will be tracked using RFID tags.

CURING

Staff will be trained to perform the necessary procedures to complete the curing process as follows:

1. Trimmed cannabis is placed into curing bins with lids.
2. Over the course of about one (1) week, bins are manually opened and closed every two (2) to four (4) hours, to slowly let out the remaining water weight.
3. The trimmed cannabis is then rotated in the curing bin and turned over intermittently.
4. These procedures will allow buds to fully dry and increase the flavor and aroma of the final product. Trimmed cannabis is considered fully dry, cured and ready for consumption when the stem in the middle can snap easily. Once the curing process is complete, the product is ready to be packaged and sold to state-licensed dispensaries.

PRODUCT MANAGEMENT

Storage of Medical Marijuana

Medical cannabis inventory will be kept in a secured, restricted-access area. All products will be accounted for in the inventory control system. The storage area is of a suitable size to maintain the quantities of medical cannabis that Kanaplya intends to cultivate and distribute.

The storage area has sufficient lighting and ventilation to support the desired temperature and humidity conditions to maintain high-quality medical cannabis products. All cannabis produced will be processed then packaged and stored in appropriate containers that will facilitate a first-in first-out distribution method. Agents will package, weigh, barcode and record all cannabis cultivated at the facility for entry into the inventory system prior to distribution.

Product Testing

Testing from a licensed laboratory will occur prior to any products being available for distribution. Cultivation agents will perform visual inspections of product types, product count, and product quality, and will report any quality control issues to a supervisor. This process will allow agents to understand cannabinoid profiles, recognize faulty labels, and report problems, as appropriate. Additionally, cultivation agents will know how to safely handle, prepare, weigh, and package all varieties of marijuana products in a sanitary manner.

RECOROKEEPING

Kanaplya has a recordkeeping plan in place to maintain, update, and store records related to its operations. The recordkeeping plan will allow Kanaplya to comply with the City of Santa Rosa audits and inspections.

INVENTORY CONTROL PLAN

Kanaplya will monitor and track its inventory with a real-time, web-based inventory control system. Information for each piece of inventory; seeds, clones, plants, trim, and flowers will be tracked from seed to sale or disposal.

ENVIRONMENTAL PLAN

Kanaplya wants to set an example for businesses in the local area as well as cultivation centers throughout the state by showing how environmentally sound a cultivation center can be. In addition to reducing its draw of resources, Kanaplya is committed to reducing the waste it generates. Landfill capacity is not unlimited, and every business has an obligation to make sure that they are not creating more waste than necessary.

Electricity

Kanaplya plans to install LED lighting in all common areas and outdoor area lighting fixtures. To reduce the energy consumed for production Kanaplya will install high efficacy HVAC equipment and HID production lighting. Currently it optimizes electrical usage by efficient lighting and cooling systems however Kanaplya's management intends to explore to possibility of solar generation in the future.

Water

Kanaplya will utilize precision nutrient application systems to reduce water consumption. In addition, Kanaplya will employ a technique of reclaiming, filtering and reusing condensation from its HVAC and dehumidification equipment. Utilizing this technique it is possible to operate on less than 50% of the water used by traditional growing facilities.

Recycling

Kanaplya will implement a recycling program at the facility. Receptacles will be placed in convenient locations throughout the facility. All glass, plastic, and aluminum will be collected and picked-up for delivery to a nearby recycling center.