



**FOR LEASE**  
**864+/- Sq. Ft. Downtown Office**

**NEW PRICE**  
**\$1250 PER MONTH**



**431 Humboldt Street**  
**Santa Rosa, CA 95404**



**BROKER:**  
**Nick Abbott**  
CA BRE # 01357548  
Phone: 707-523-2700 ext 305  
Cell: 707 529-1722  
Fax: 707-526-4311  
Email: [nabbott@northbayprop.com](mailto:nabbott@northbayprop.com)



**BROKER:**  
**William Severi**  
CA BRE # 01000344  
Phone: 707-523-2700 ext 302  
Cell: 707 291-2722  
Fax: 707-891-3050  
Email: [bill@northbayprop.com](mailto:bill@northbayprop.com)

**2777Cleveland Ave # 110**  
**Santa Rosa, CA 95403**  
**707-523-2700 Main**  
**707-526-4311 Fax**  
**[www.northbayprop.com](http://www.northbayprop.com)**

The above information, while not guaranteed, has been secured from sources we believe to be reliable. This is not an offer to sell or lease and is subject to change or withdrawal. An interested party should verify the status of the property and the information herein.



**ADDRESS:**

**431 Humboldt Street, Santa Rosa, CA 95404**

Studio #	Sq. Ft.	Lease Rate:
G	864+/-	\$1250

Convenient downtown location with on site parking. Building has been renovated with first class finishes. Property has common area restrooms, a private courtyard, all new landscaping, excellent light. Studio G has extensive glass line and directly adjacent to on sit parking. Available now!



The above information, while not guaranteed, has been secured from sources we believe to be reliable. This is not an offer to sell or lease and is subject to change or withdrawal.

An interested party should verify the status of the property and the information herein.

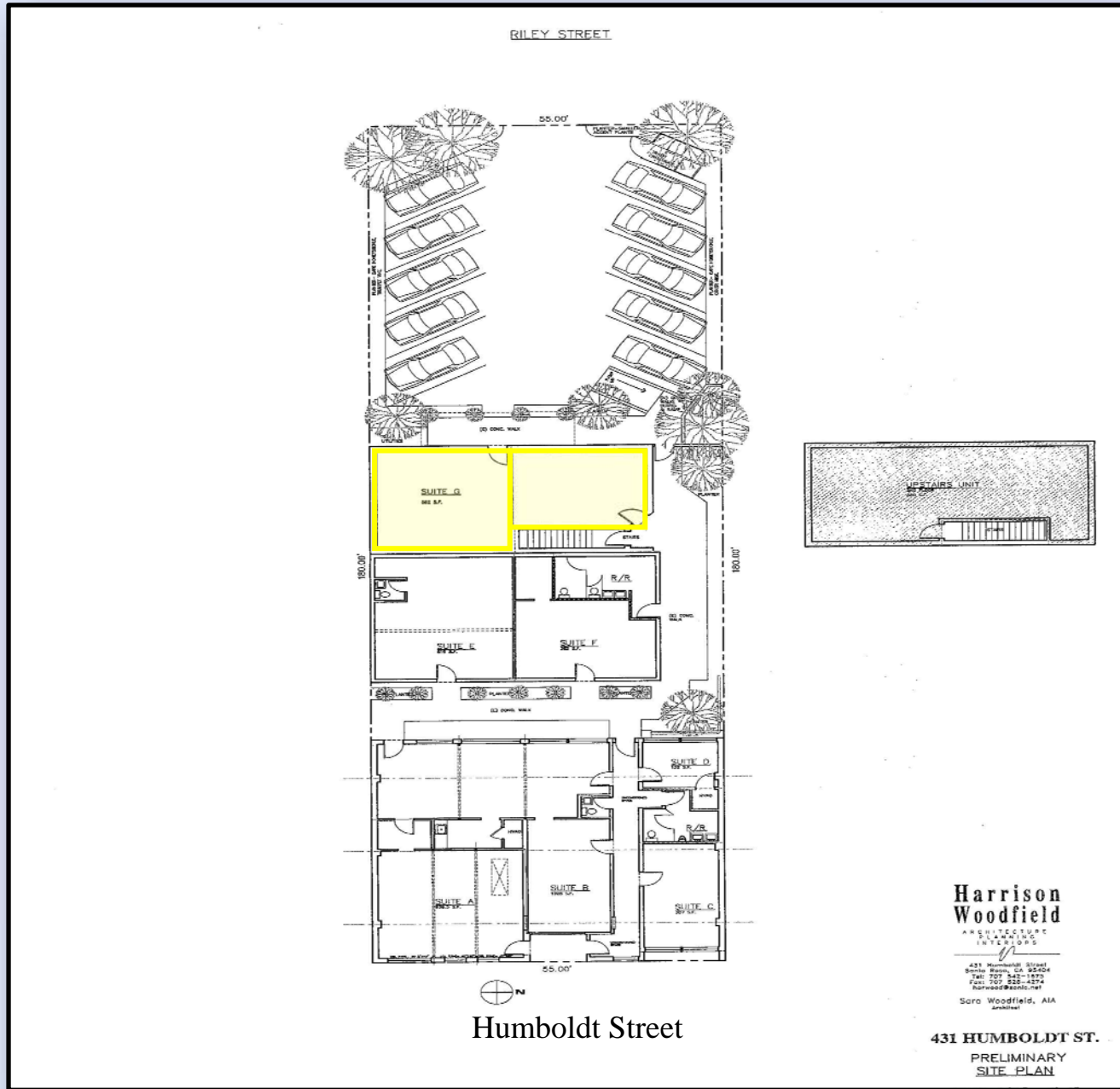

The above information, while not guaranteed, has been secured from sources we believe to be reliable. This is not an offer to sell or lease and is subject to change or withdrawal.

An interested party should verify the status of the property and the information herein.



**Nick Abbott**  
nabbott@northbayprop.com



**Cell:**  
707-529-1722  
**Phone:**  
707-523-2700 ext 305  
**BRE No.:**  
01357548

**William Severi, CCIM CPM**  
bill@northbayprop.com



**Cell:**  
707-291-2722  
**Phone:**  
707-523-2700 ext 302  
**BRE No.:**  
01000344

**Santa Rosa Office:**  
2777 Cleveland Ave., Ste., 110  
Santa Rosa, CA 95403  
707-523-2700



**Northern California Offices**

- Santa Rosa
- Novato
- Sonoma / Napa
- San Jose
- Sacramento
- Walnut Creek
- San Francisco

The above information, while not guaranteed, has been secured from sources we believe to be reliable. This is not an offer to sell or lease and is subject to change or withdrawal.

An interested party should verify the status of the property and the information herein.