



FOR LEASE

WAREHOUSE / LIGHT INDUSTRIAL

1000 PINER ROAD UNIT D-2, SANTA ROSA

Northern California's Premier Commercial Real Estate Firm



Daniel Silewicz

CA BRE # 01988015

Phone: 707-523-2700

Cell: 707-328-1141

Email: daniel@northbayprop.com

North Bay Property Advisors

2777 Cleveland Ave. Suite 110

Santa Rosa, CA 95403

707-523-2700

www.NorthBayProp.com



The above information, while not guaranteed, has been secured from sources we believe to be reliable. This is not an offer to sell or lease and is subject to change or withdrawal. Any interested party should verify the status of the property and the information herein.



PROPERTY SUMMARY

1000 Piner Road Unit D-2, Santa Rosa	
Approximate Size	864 +/- Sq. Ft.
Monthly Rent	\$1,500 (base yr. 1) \$242 (CAM estimate) \$1,742 (Per Month)
PG & E Reimbursement	\$75.00 per month yr. 1
Roll-up Door Clear Height	12 Feet
Fire Suppression	Yes
Parking	2 in front of space
HVAC	Heat, but no AC
Restrooms	One Private



1000 Piner Unit D-2 (Hard to find small industrial space)

The Property is located in a well-traveled area that has numerous restaurants, retail, industrial and other commercial uses nearby. The site has excellent signage on Piner Rd. at the controlled intersection of Piner and Airway Drive. The property is a short distance to the Coddington Shopping Center and U.S. Hwy 101. Unit D-2 has one 12' x 12' roll up door, reception/main entry, private restroom, heater, and fire suppression.



SITE PLAN



The above information, while not guaranteed, has been secured from sources we believe to be reliable. This is not an offer to sell or lease and is subject to change or withdrawal. Any interested party should verify the status of the property and the information herein.



FLOOR PLAN

1000 PINER ROAD SUITE D-2

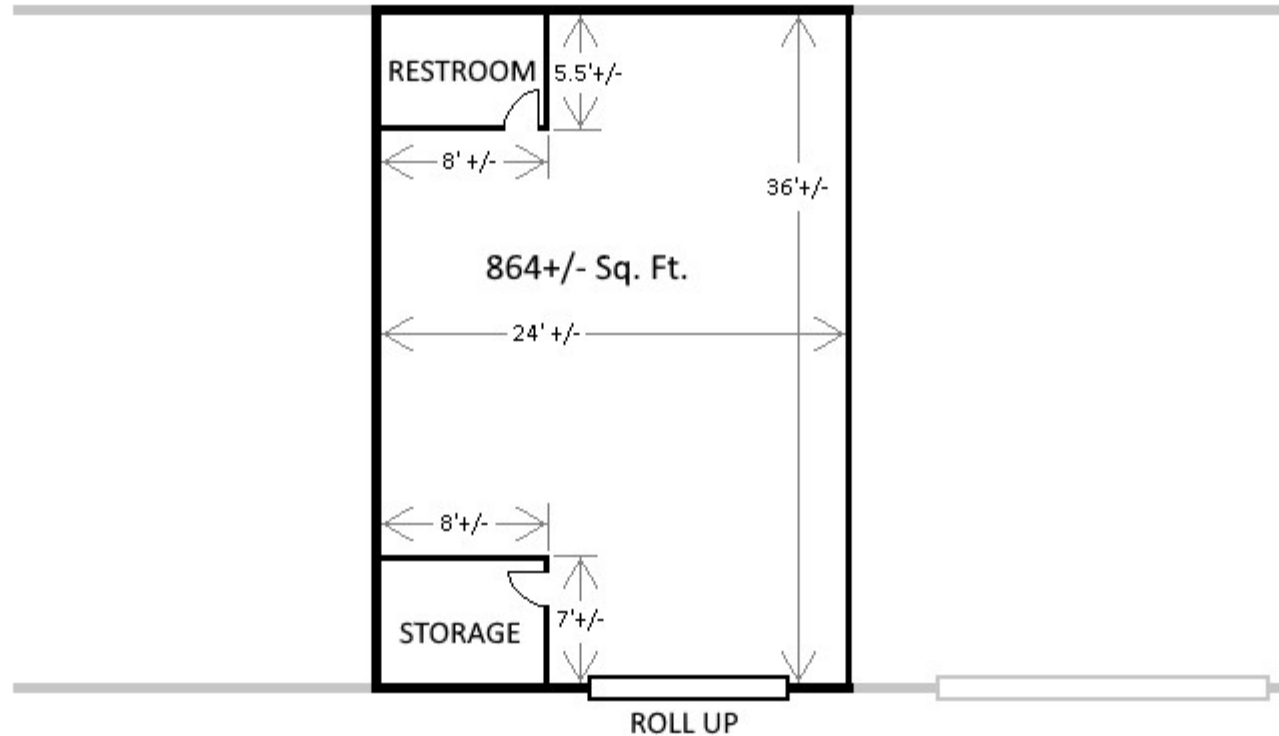



PHOTOS



The above information, while not guaranteed, has been secured from sources we believe to be reliable. This is not an offer to sell or lease and is subject to change or withdrawal. Any interested party should verify the status of the property and the information herein.



MAPS

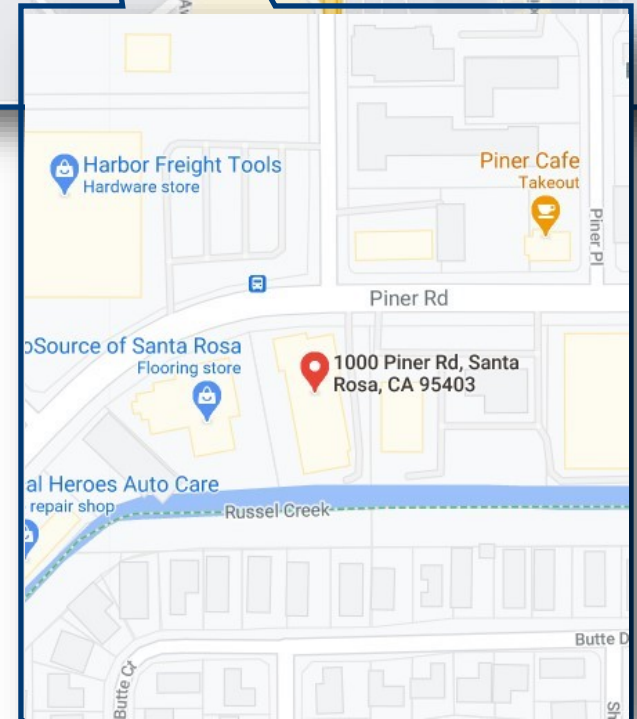
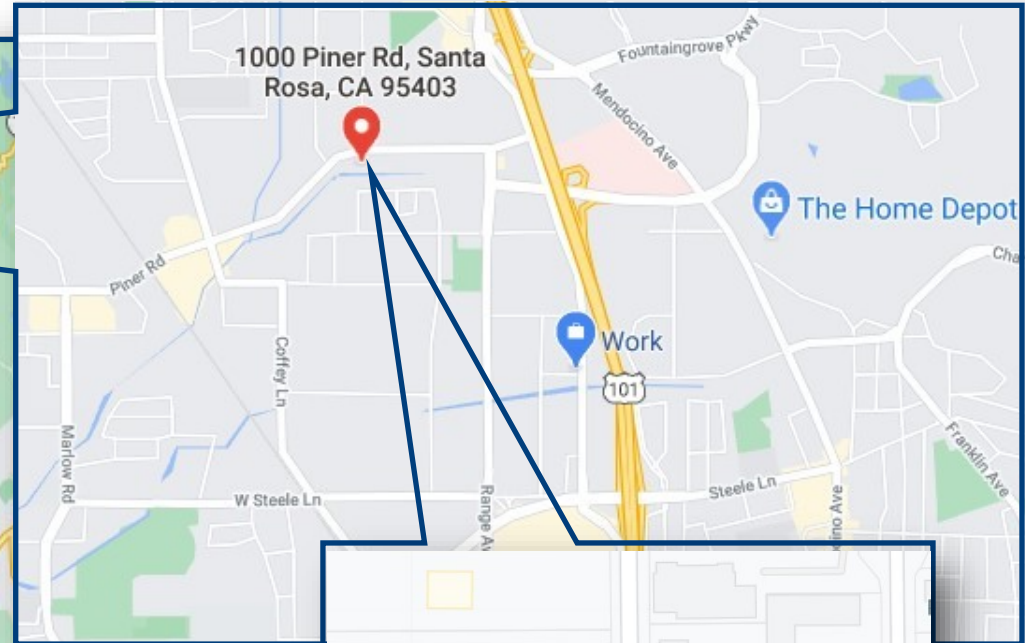
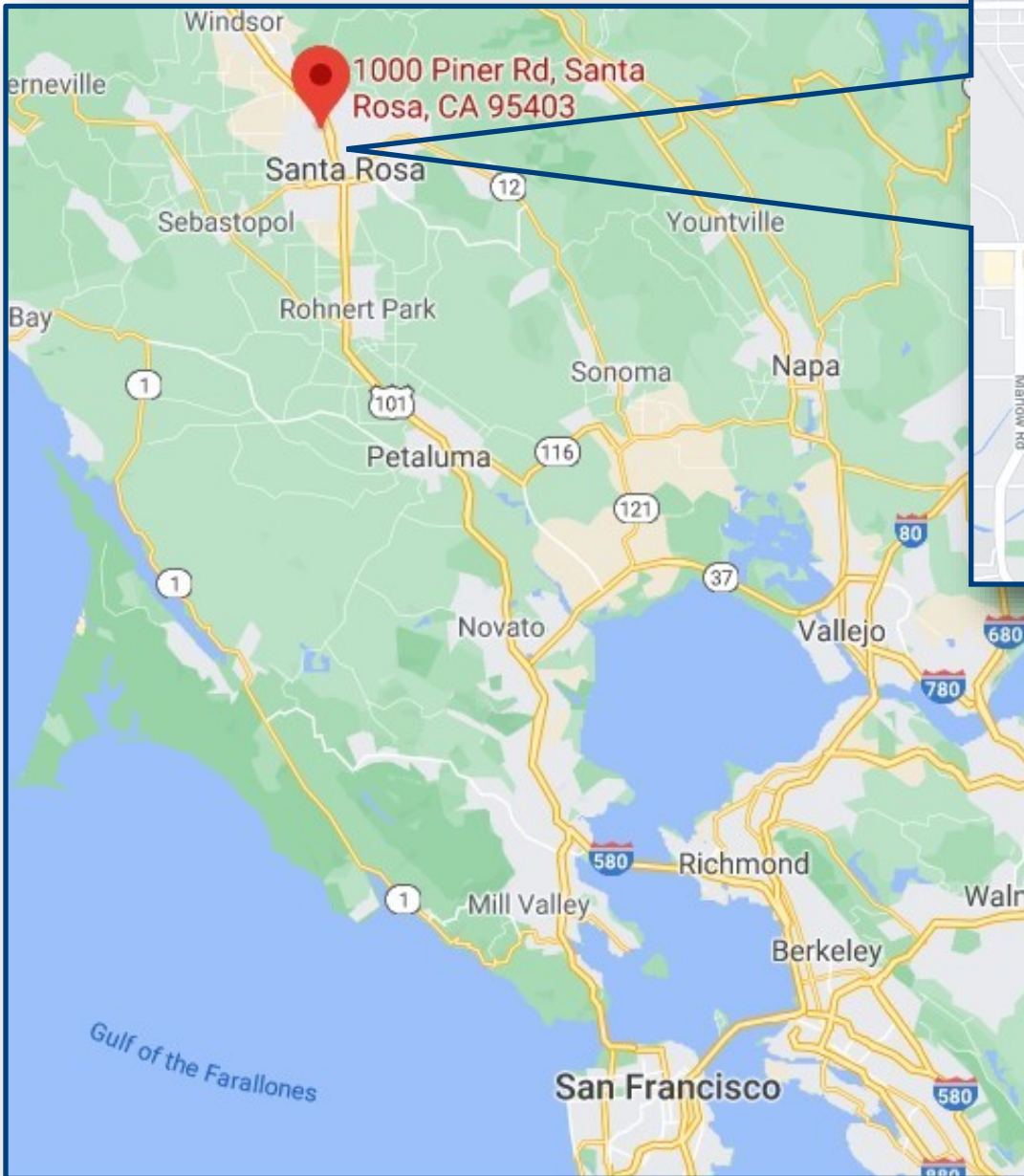

The above information, while not guaranteed, has been secured from sources we believe to be reliable. This is not an offer to sell or lease and is subject to change or withdrawal. Any interested party should verify the status of the property and the information herein.



LISTING TEAM



Daniel Silewicz

CA BRE # 01988015

Phone: 707-523-2700

Cell: 707-328-1141

Email: daniel@northbayprop.com

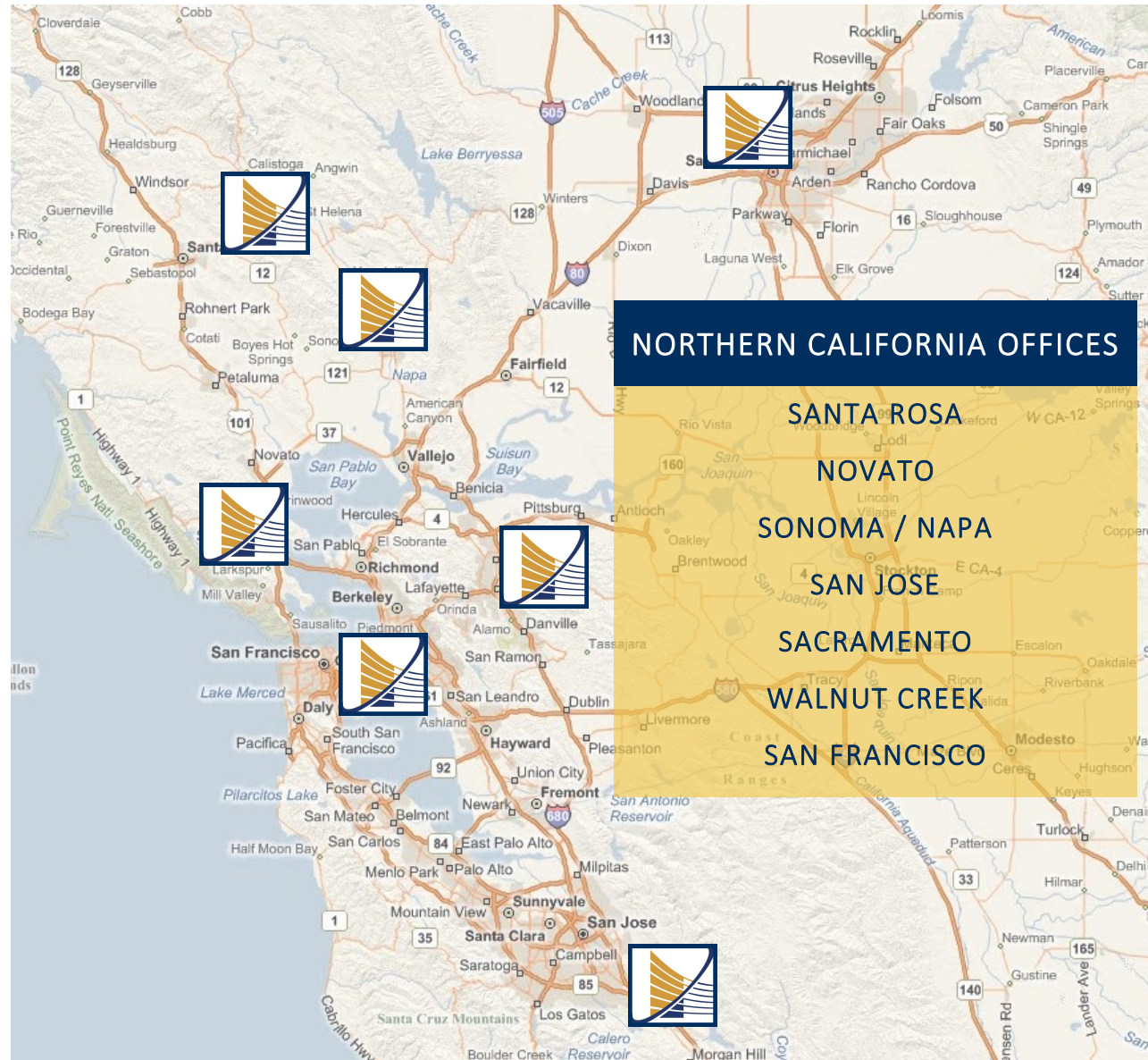

North Bay Property Advisors

Santa Rosa Office

2777 Cleveland Ave. Suite 110

Santa Rosa, CA 95403

707-523-2700

www.NorthBayProp.com

The above information, while not guaranteed, has been secured from sources we believe to be reliable. This is not an offer to sell or lease and is subject to change or withdrawal. Any interested party should verify the status of the property and the information herein.