



# FOR LEASE

## PROFESSIONAL SERVICE / OFFICE SPACE

### 1625 TERRACE WAY, SANTA ROSA

*Northern California's Premier Commercial Real Estate Firm*



**1625 Terrace Way Office Suites** offers 2 suites of approximately 1,100+/- Sq. Ft. each. Suite A offers 3 offices, reception area, private restroom, kitchenet and storage room. Suite B offers one executive office, open work area or room for other private offices, 2 restrooms and kitchenet. Property is located adjacent to the prestigious McDonald neighborhood, Towns & Country Shopping Center and Pacific Market, offering numerous amenities and a very quite and peaceful setting. This along with private parking, signage, and attractive grounds make this space great for professional services or private office.

The above information, while not guaranteed, has been secured from sources we believe to be reliable. This is not an offer to sell or lease and is subject to change or withdrawal. Any interested party should verify the status of the property and the information herein.



# FLOOR PLAN

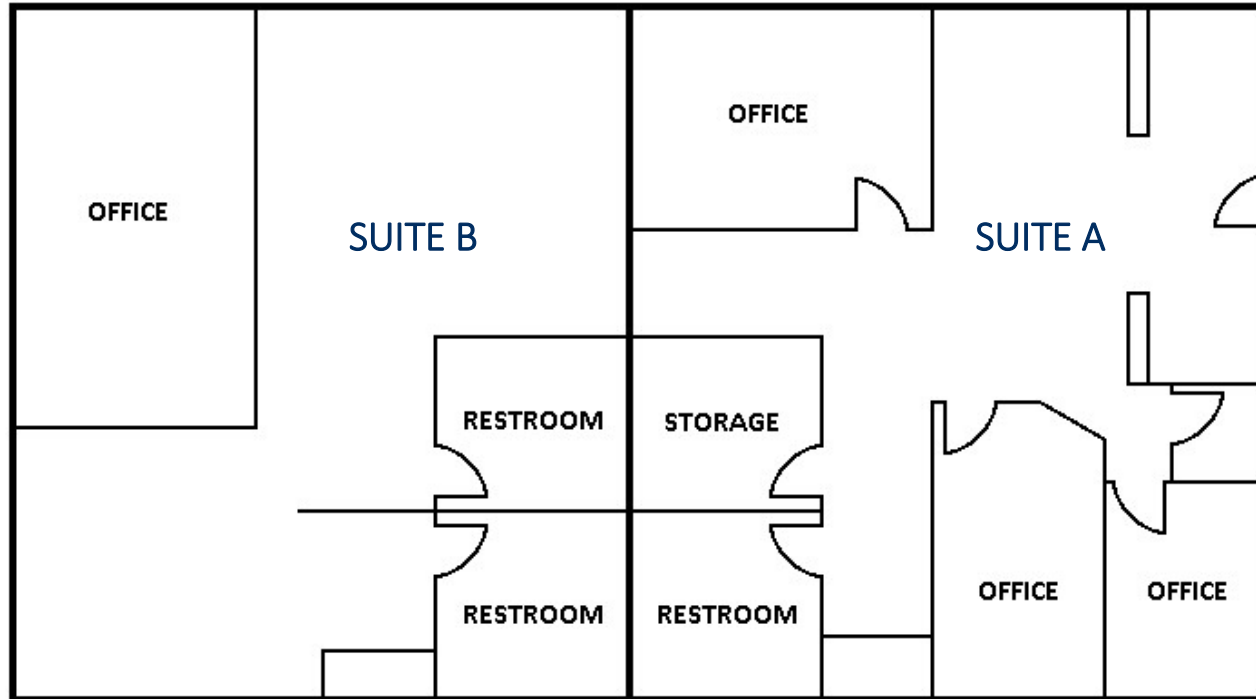

The above information, while not guaranteed, has been secured from sources we believe to be reliable. This is not an offer to sell or lease and is subject to change or withdrawal. Any interested party should verify the status of the property and the information herein.