



# FOR LEASE : WAREHOUSE

30 D MILL STREET, HEALDSBURG, CA 95448

10,000 +/- Sq. Ft. \$0.90 per Sq. Ft. + NNN

*Northern California's Premier Commercial Real Estate Firm*



**Nick Abbott - Broker**

CA BRE # 01357548

Phone: 707-523-2700

Cell: 707-529-1722

Email: [nabbott@northbayprop.com](mailto:nabbott@northbayprop.com)



**Daniel Silewicz**

CA BRE # 01988015

Phone: 707-523-2700

Cell: 707-328-1141

Email: [daniel@northbayprop.com](mailto:daniel@northbayprop.com)



The above information, while not guaranteed, has been secured from sources we believe to be reliable. This is not an offer to sell or lease and is subject to change or withdrawal. Any interested party should verify the status of the property and the information herein.



# OVERVIEW

SUITE	APPROXIMATE SQ. FT.	Lease Rate	ROLL UP DOOR	POWER
30 D	10,000	\$0.90 sq. ft. - NNN	3 grade level roll up-doors	400 Amps

This standalone industrial building holds 10,000 +/- Sq. Ft. in the Plum Industrial Park located in central Healdsburg. The building offers 3 grade level doors, fire suppression sprinklers, fully insulated, and power supply of 400 amps 3 phase. The space offers a large open warehouse area with approximately 18' clear height. The existing occupant built out 768 sq. Ft. of ground floor production area adjacent to the original office area. Located on the ground floor there is 228 +/- Sq. Ft. of ground floor office, and two restrooms. The second floor has an office with 400 +/- Sq. Ft. The building is zoned "Industrial", which allows for a variety of industrial uses. The Plum Business Park consists of multiple buildings, which may allow for future expansion.



The above information, while not guaranteed, has been secured from sources we believe to be reliable. This is not an offer to sell or lease and is subject to change or withdrawal. Any interested party should verify the status of the property and the information herein.



# PHOTOS



The above information, while not guaranteed, has been secured from sources we believe to be reliable. This is not an offer to sell or lease and is subject to change or withdrawal. Any interested party should verify the status of the property and the information herein.



# FLOOR PLAN

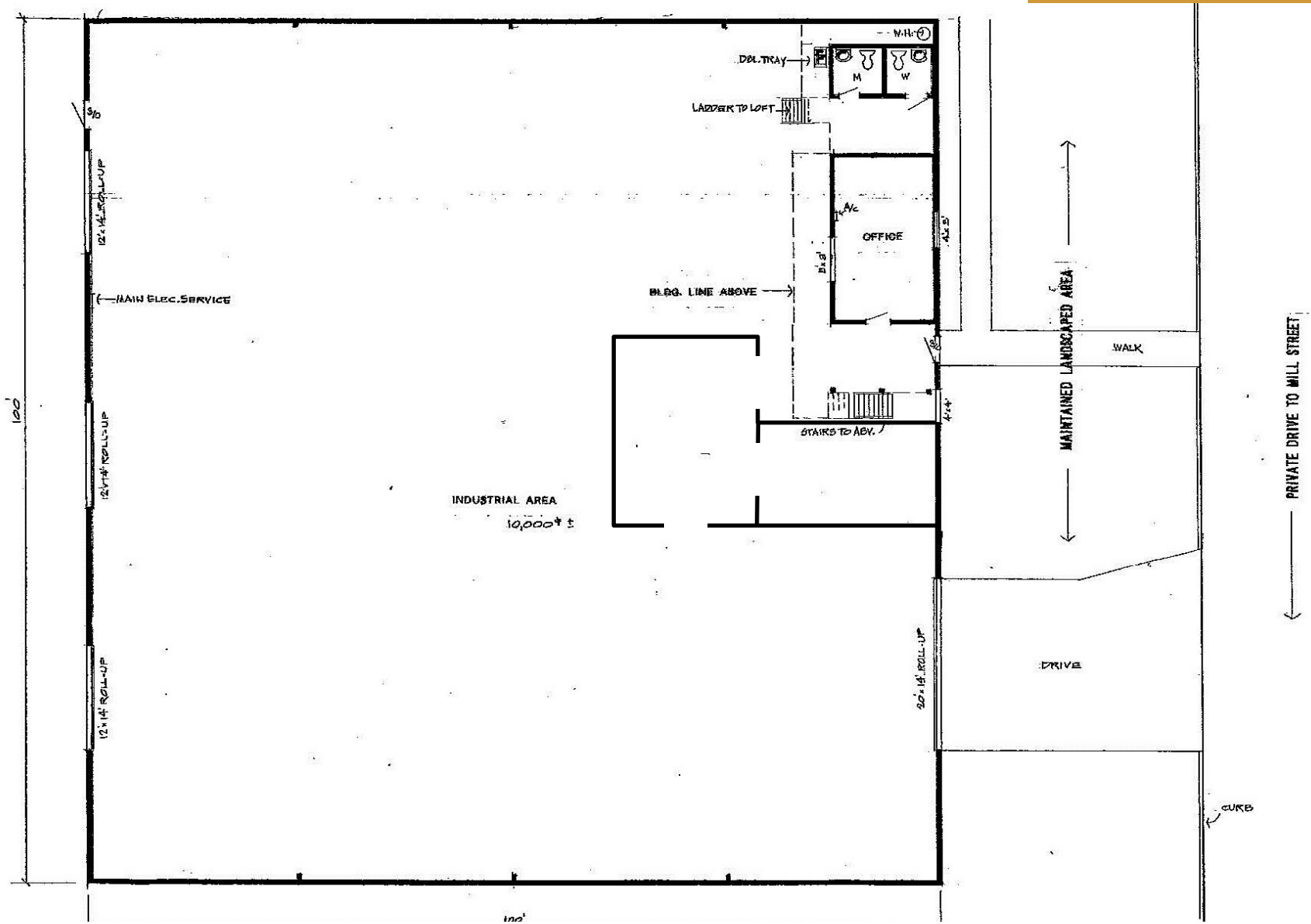

The above information, while not guaranteed, has been secured from sources we believe to be reliable. This is not an offer to sell or lease and is subject to change or withdrawal. Any interested party should verify the status of the property and the information herein.



# AERIAL MAP



The above information, while not guaranteed, has been secured from sources we believe to be reliable. This is not an offer to sell or lease and is subject to change or withdrawal. Any interested party should verify the status of the property and the information herein.



# MAPS

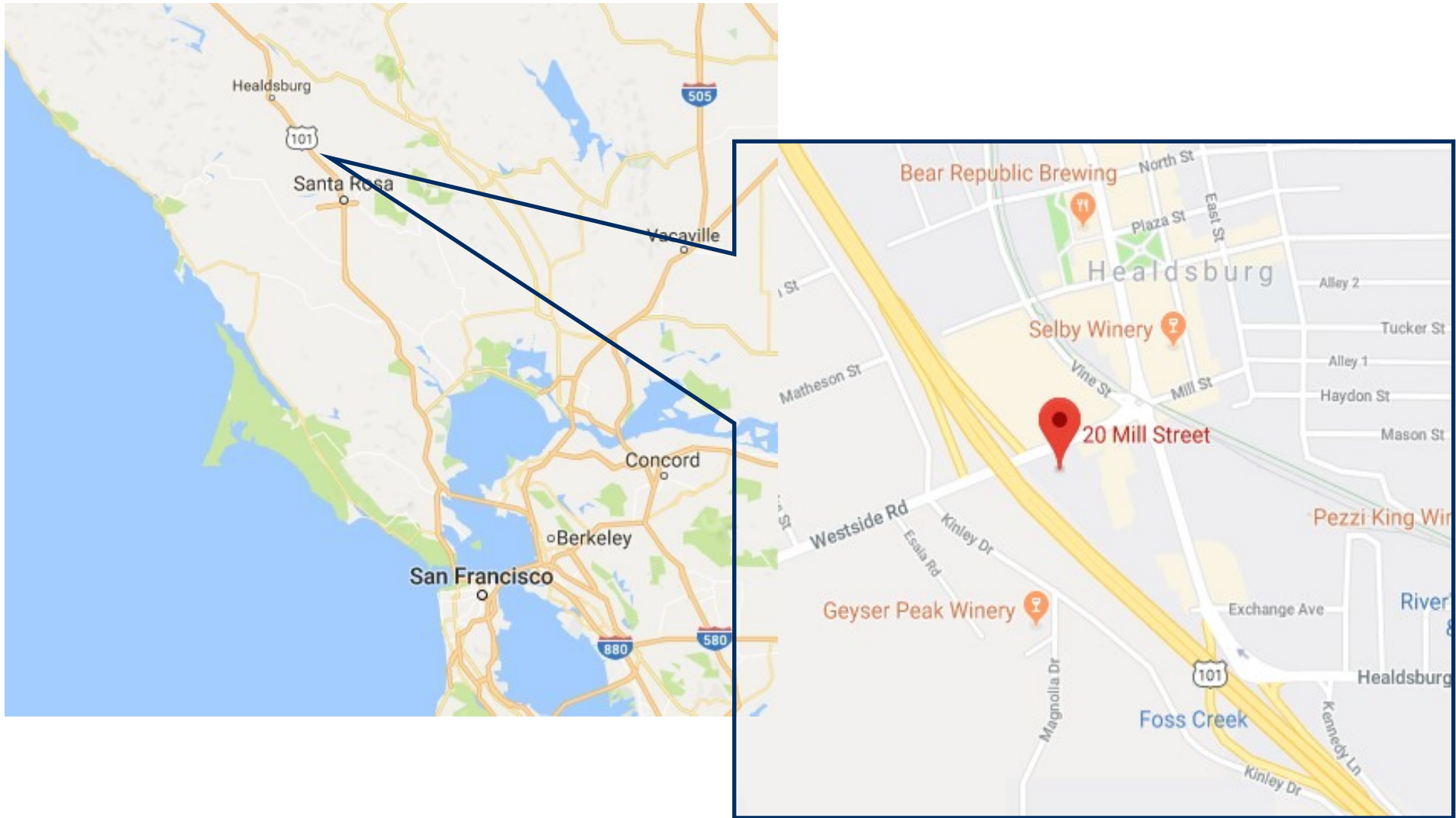

The above information, while not guaranteed, has been secured from sources we believe to be reliable. This is not an offer to sell or lease and is subject to change or withdrawal. Any interested party should verify the status of the property and the information herein.



# LISTING TEAM



**Nick Abbott - Broker**

CA BRE # 01357548

Phone: 707-523-2700

Cell: 707-529-1722

Email: [nabbott@northbayprop.com](mailto:nabbott@northbayprop.com)

**North Bay Property Advisors**

**Santa Rosa Office**

2777 Cleveland Ave. Suite 110

Santa Rosa, CA 95403

707-523-2700

[www.NorthBayProp.com](http://www.NorthBayProp.com)

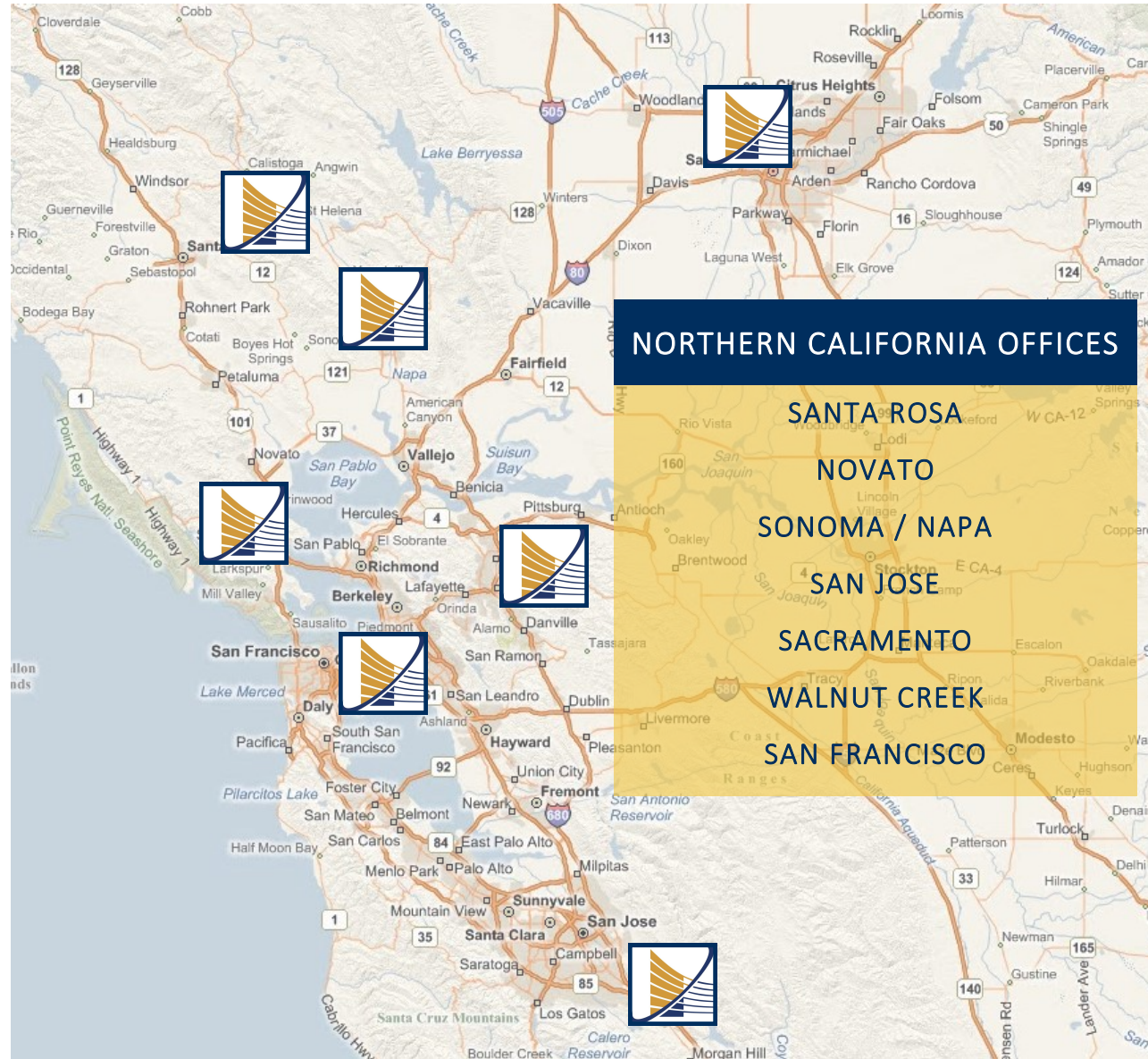

## NORTHERN CALIFORNIA OFFICES

SANTA ROSA

NOVATO

SONOMA / NAPA

SAN JOSE

SACRAMENTO

WALNUT CREEK

SAN FRANCISCO

The above information, while not guaranteed, has been secured from sources we believe to be reliable. This is not an offer to sell or lease and is subject to change or withdrawal. Any interested party should verify the status of the property and the information herein.